

**Bluetooth** Connect with mobile device by i-BTPSENSOR application via Bluetooth Low Energy 5.0

**i-BTPSENSOR instruction**  
 ※Install the tire pressure sensors with F mark sensor on the front wheel and with R mark sensor on the rear wheel.

1. Put in battery (CR1632)



2. Remove the Presta valve core with the Wrench Tool

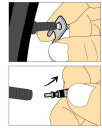

3. Screw the Tire Pressure Sensors into the Presta stem. Use the wrench tool to tighten it securely.



4. Adjust the Sensor to align with the wheel

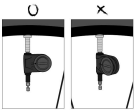

5. Inflate the tires  
 6. Turn on the i-BTPSENSOR and push the wheel. The i-BTPSENSOR will automatically connect to the Sensors and show the tire pressure when signal detected.

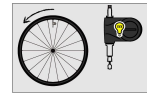

Push the wheels and activate the Sensor. The indicator light will turn on.

p.s 1. If there is no signal detected after push the wheels, please check  
 (a) The mobile device has Bluetooth turned on  
 (b) The battery level of Tire Pressure Sensor  
 (c) The battery installation direction  
 2. The connection range is around 5 to 10 meters



**Set up your Tire Pressure Sensor**

1. Download "i-BTPSENSOR" application from Google Play Store or APP Store  
 2. Connection  
 (1) Pair automatically



(2) Pair manually  
 If can not pair the Sensor after searching for 2 mins, touch the pressure block to next page

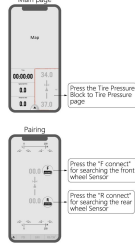

**i-BTPSENSOR introduction**

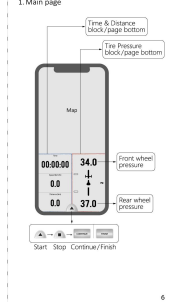

※Indicator light  
 The Sensors would record the last pressure setting range  
 Green Light: Tire pressure in the setting range  
 Red Light: Tire pressure out of the setting range (Please check the tire pressure immediately)

2. Tire Pressure page  
 Preset tire pressure & Choose the unit of pressure

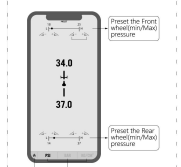

3. Time and Distance page  
 Choose the unit of distance & Security Alarm



Download i-BTPSENSOR to the GARMIN device via the CONNECT IQ app

1. Download the CONNECT IQ app to your mobile phone



※Make sure your GARMIN device had connected to your mobile phone successfully. If not, the i-BTPSENSOR could not be installed.

2. Open the CONNECT IQ app



3. Search the i-BTPSENSOR

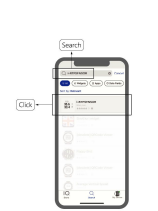

4. Install

5. Search the Connect IQ-1/10 in your GARMIN device, if you see the i-BTPSENSOR on the list. Then, the installation is successfully



Add the tire pressure data field in the data screen

**CAUTION**  
 1. Risk of fire or explosion if the battery is replaced by an incorrect type.



i-BTPSENSOR App available at App Store & Google Play

**WARNING**  
 THE PRODUCT CONTAINS BUTION BATTERY  
 KEEP OUT OF REACH OF CHILDREN  
 Swallowing can lead to chemical burns, perforation of soft tissue, and death. Severe burns can occur within 2 hours of ingestion. Seek medical attention immediately.

Bluetooth is a registered trademark of Bluetooth SIG, Inc.  
 iPhone is a registered trademark of Apple Inc.  
 App Store is a service mark of Apple Inc.

Made in Taiwan