

GIYO

W/EXTRACTABLE HOSE

MAX. 120 PSI



GIYO

W/EXTRACTABLE HOSE

MAX. 120 PSI

GP-87T
max. 120 psi

GP-872T W/GAUGE
max. 120 psi

- Aluminum barrel w/ T-Handle
- Extractable hose
- Clever-Twin-Valve for Schrader, Presta and Dunlop



All-around gauge

GP-872T

Instruction

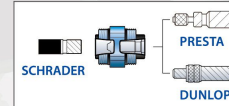

▲ Clever-Twin-Valve

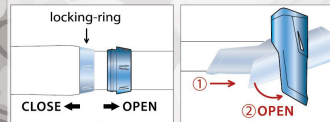

▲ T-Handle

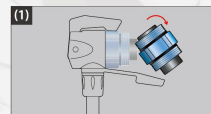

Choose correct pump valve.



Engage to the valve of tire. Push down the lever to lock the valve.

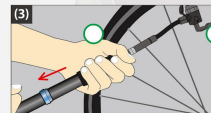

Push locking-ring toward pump T-Handle direction until handle won't touch locking-ring, then inflate.

(4) After inflating desired pressure, unlock the lever and take the pump head off the tire.

Made in Taiwan