

GIYO

CNC MINI PUMP W/EXTRACTABLE HOSE & CNC GAUGE

GP-861L
M/C/

GP-871L
M/C/R



GIYO

CNC MINI PUMP W/EXTRACTABLE HOSE & CNC GAUGE

GP-861L
M/C/

GP-871L
M/C/R

Features

- High quality CNC gauge hide

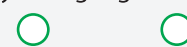

- Reversible Presta and Schrader with Thumb-Lock lever
- Aluminum handle and barrel
- Extractable hose
- Dust cap
- Max. pressure 80 psi (GP-861L)
- Max. pressure 110 psi (GP-871L)

Instruction

OPEN

1. Pull pump head out of the handle hole
2. Pull handle to separate from locking-ring on barrel.
3. Push locking-ring toward pump end-cap direction until handle won't touch locking-ring then engage to the valve of tire. (fig 1)
4. Push down the lever to lock the valve. (fig 2)
5. Inflate

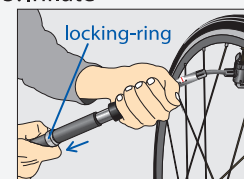

(fig 1)

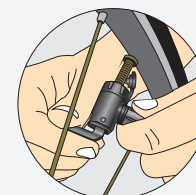

(fig 2)

CLOSE

1. Close handle to barrel.
2. Push forward locking-ring to lock handle until handle won't moving. (fig 3)

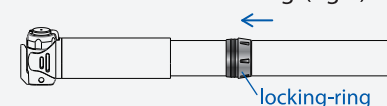

(fig 3)

GP-861L with CNC gauge



GP-871L with CNC gauge

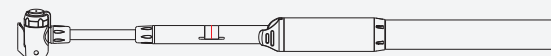

Made in Taiwan