



# GIYO

## SWIVEL DUAL FACE GAUGE FLOOR PUMP MAX. 40/160 PSI

# GIYO

40 → 160

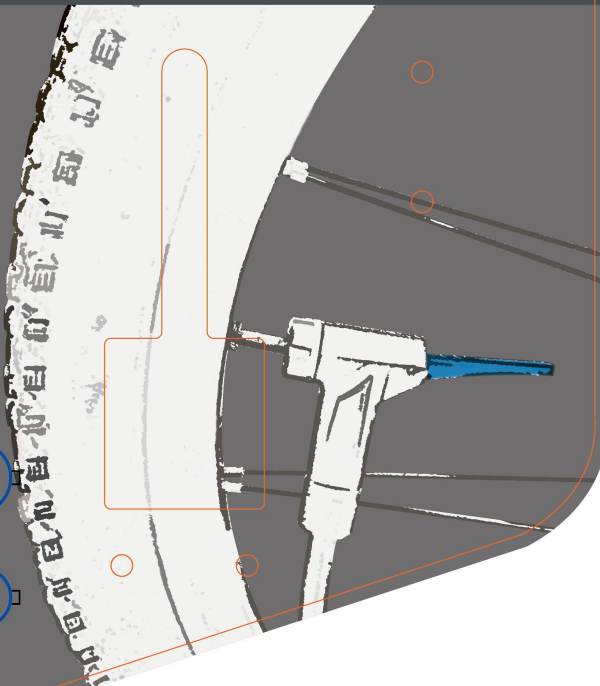

# GIYO

## SWIVEL DUAL FACE GAUGE FLOOR PUMP

**GF-69PV**  
40psi / 160psi

- High volume/high pressure mode
- Easy to read lower pressure
- 1 psi digit gap shown on display board
- Top-mounted gauge for easy reading
- One side 2" gauge: Max. pressure 40 psi
- special for FAT/Mountain tire
- Swivel to another 2.5" gauge: Max. pressure 160 psi for Road tire
- Clever Valve: No more reverse for Presta and Schrader With air-bleeder

**GF-69E**  
max.40/160 psi

- Easy to read lower pressure
- 0.5 psi digit gap shown on display board
- Top-mounted gauge for easy reading
- One side 2" gauge: Max. pressure 40 psi special for FAT/Mountain tire
- Swivel to another 2.5" gauge: Max. pressure 160 psi for Road tire
- Clever Valve: No more reverse for Presta and Schrader

### INSTRUCTION

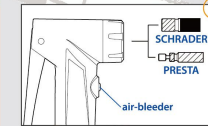

▲ Clever Valve

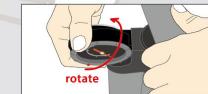

360 degree swivel dual face gauge 40/160 psi

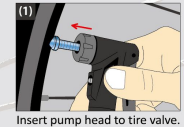

(1) Insert pump head to tire valve.



(2) Flip up the lever to securely hold the valve, then inflate.

(3) After inflating desired pressure, unlock the lever and take the pump head off the tire.

Made in Taiwan